

# Double Door Wall Cabinet

ASMBLY GUIDE WALL 2DR

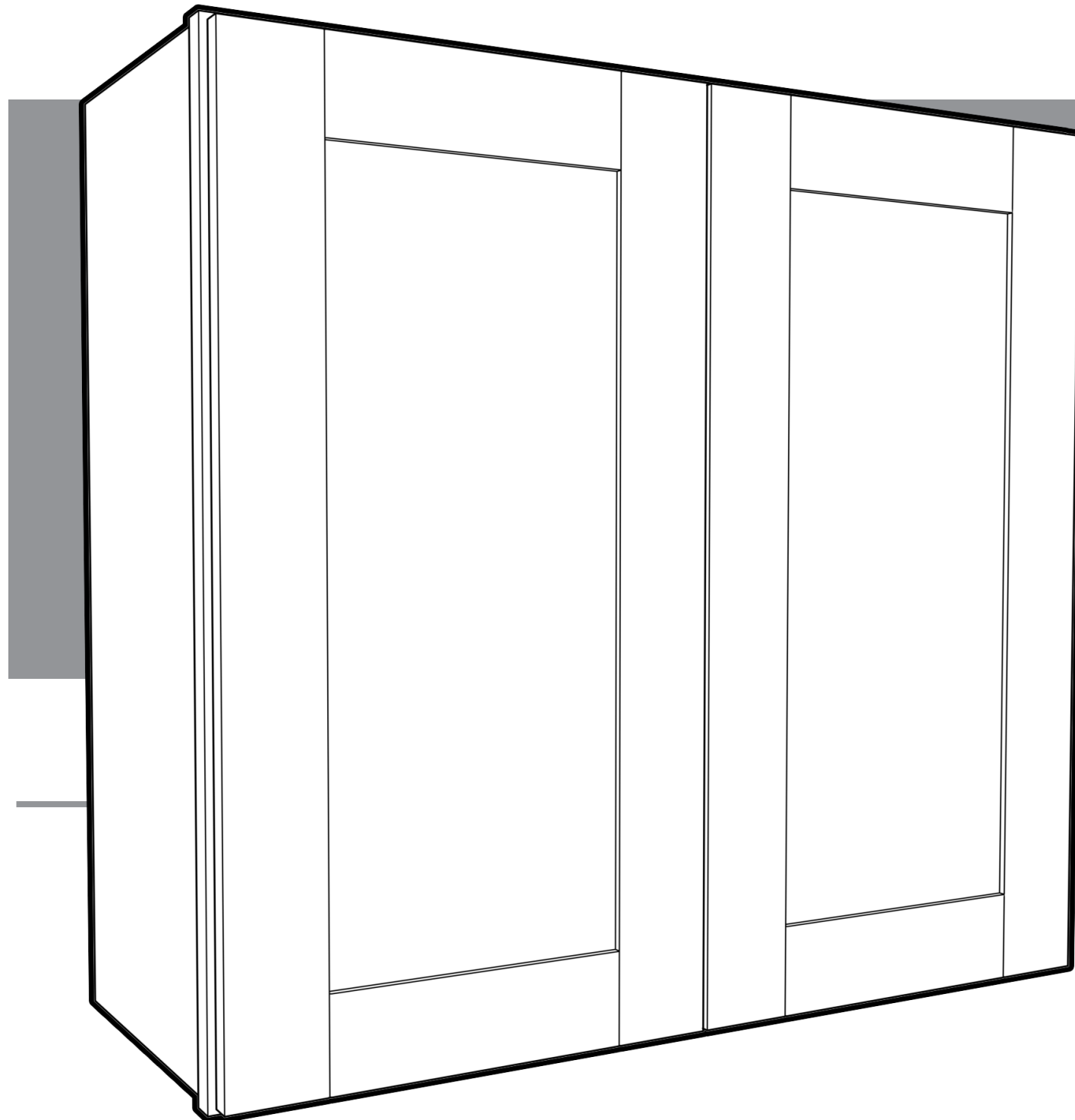

Before you start assembly, inspect all panels and hardware to ensure you have everything needed.

We recommend laying the panels on some cardboard to protect the finish when assembling.

In addition to the tan Connector Brackets supplied, we recommend that you run a bead of white wood glue into each dado groove, as you assemble, to create the strongest cabinet.

## REQUIRED TOOLS

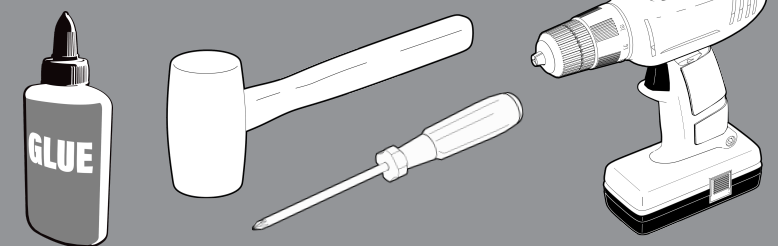

# 2 Door Wall Cabinet

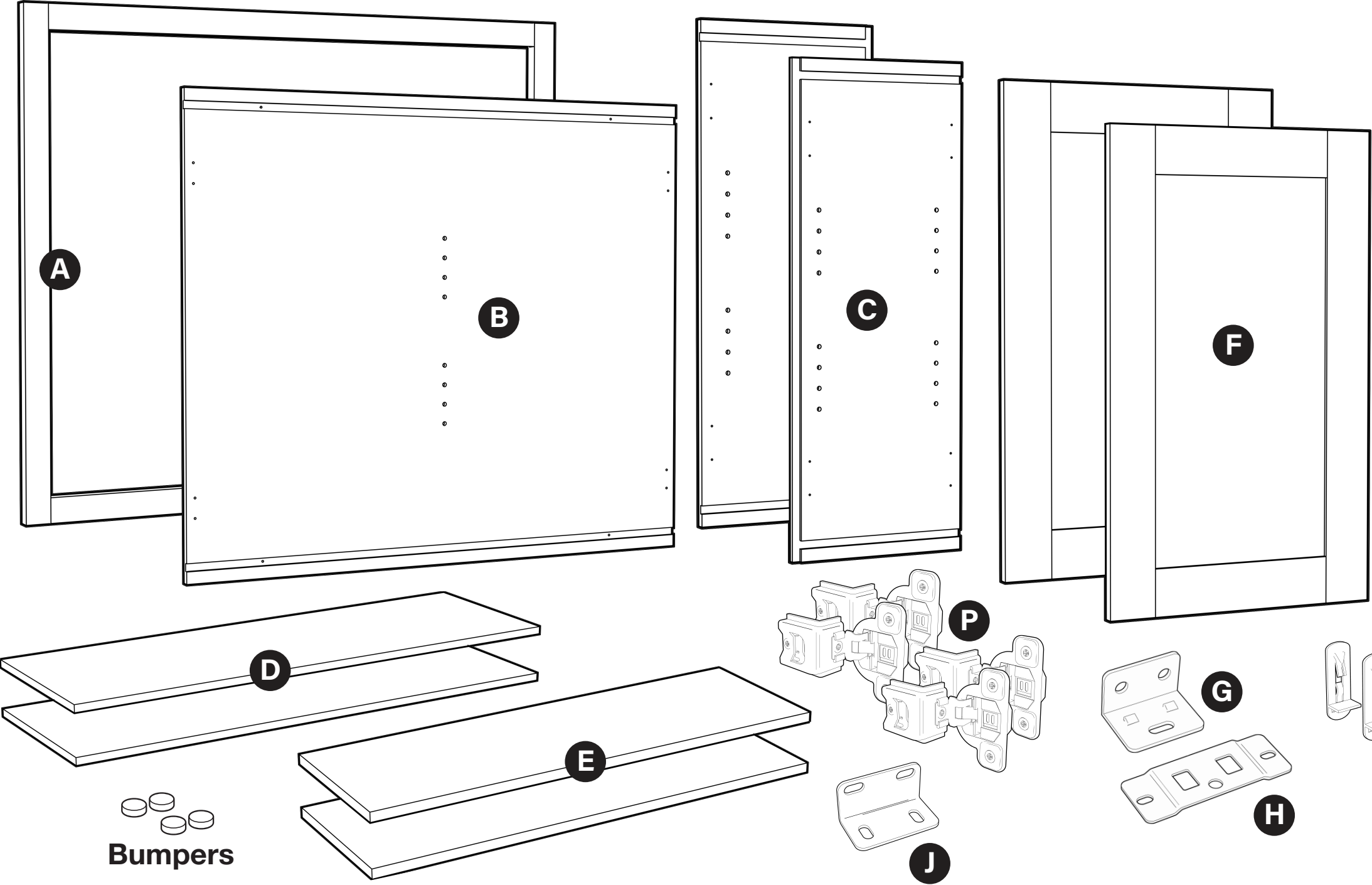

## PARTS LIST

- A** 1 x Face Frame
- B** 1 x Back Panel
- C** 2 x End Panels
- D** 2 x Fixed Shelves
- E** 2 x Adjustable Shelves\*
- F** 2 x Doors
- G** 8 x Tan RTA L-Brackets
- H** 8 x Tan RTA Connector Plates
- I** 8 x Locking Shelf Rests\*
- J** 2 x Silver L-Brackets\*\*
- P** 4 x Hinges\*

*\*36" and 42" high wall cabinets will have (3) adjustable shelves, (12) shelf rests and (6) hinges*  
*\*\*30" and 36" wide cabinets only*

**Bumpers**

- 16 - #8 x 1/2" Pan Head Screws
- 40 - #6 x 1/2" Pan Head Screws
- 16 - #6 x 5/8" Flat Countersink Screws
- 4 - #8 x 7/8" Pan Washer Head Screws
- 6 - #6 x 1" Flat Countersink Screws

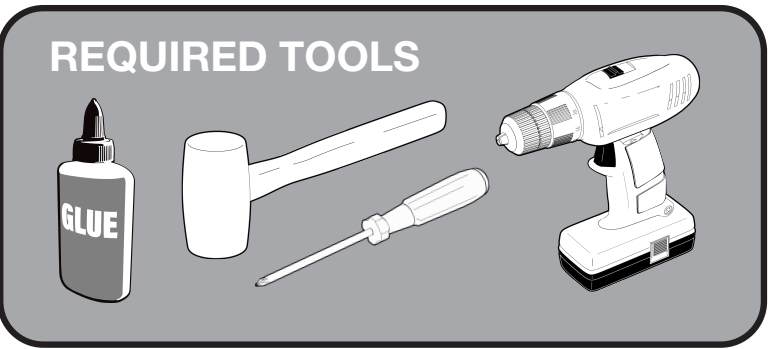

**IMPORTANT NOTES:**  
Before you start assembly, inspect all panels and hardware to ensure you have everything needed. In addition to the tan RTA Connector Brackets supplied, we recommend you run a bead of white wood glue into each groove as you assemble, to create the strongest cabinet. We also recommend laying the panels on some cardboard to protect the finish when assembling.

# STEP 1

## Parts List

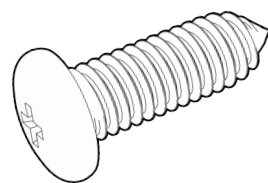

8- #6 x 1/2" Pan Head Screws

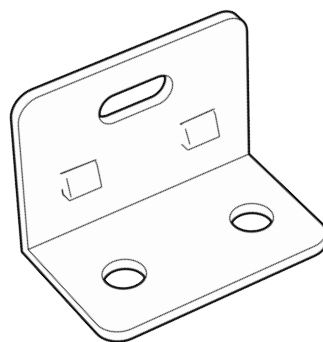

4 - Connector L-Brackets

G

TOOLS  
NEEDED

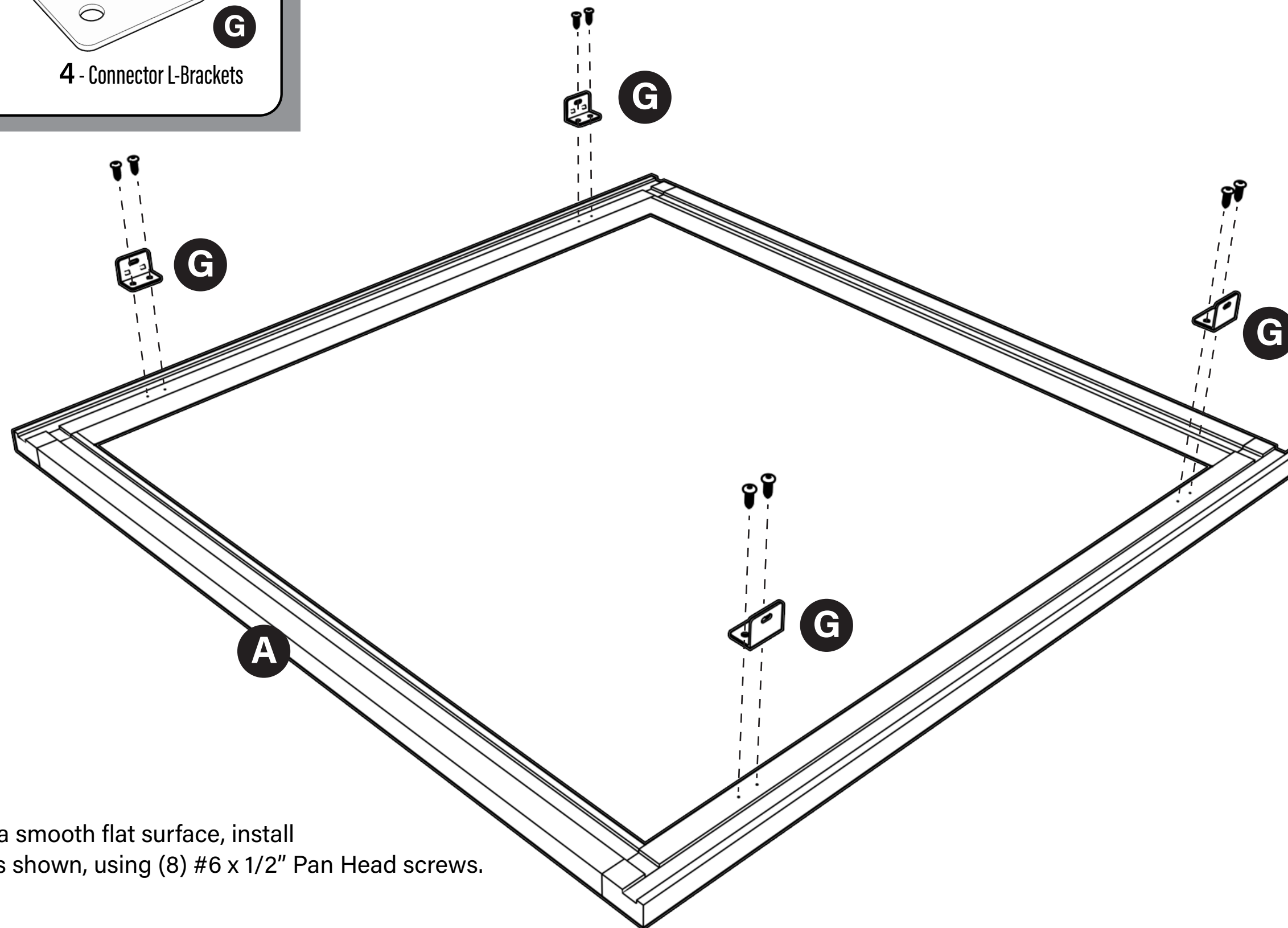
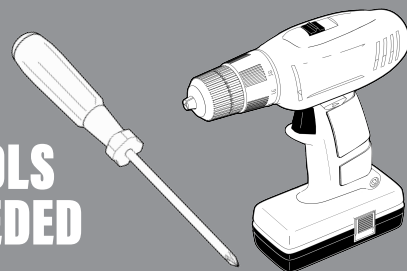

Lay Frame (A) face down on a smooth flat surface, install (4) tan RTA L-Brackets (G), as shown, using (8) #6 x 1/2" Pan Head screws.

# STEP 2

## Parts List

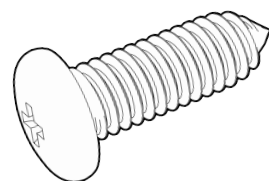

8- #6 x 1/2" Pan Head Screws

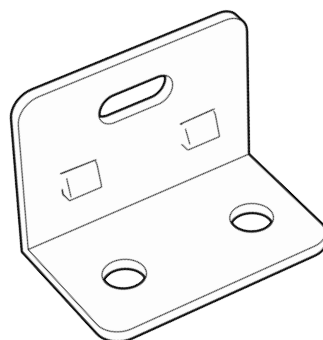

4 - Connector L-Brackets

G

TOOLS  
NEEDED

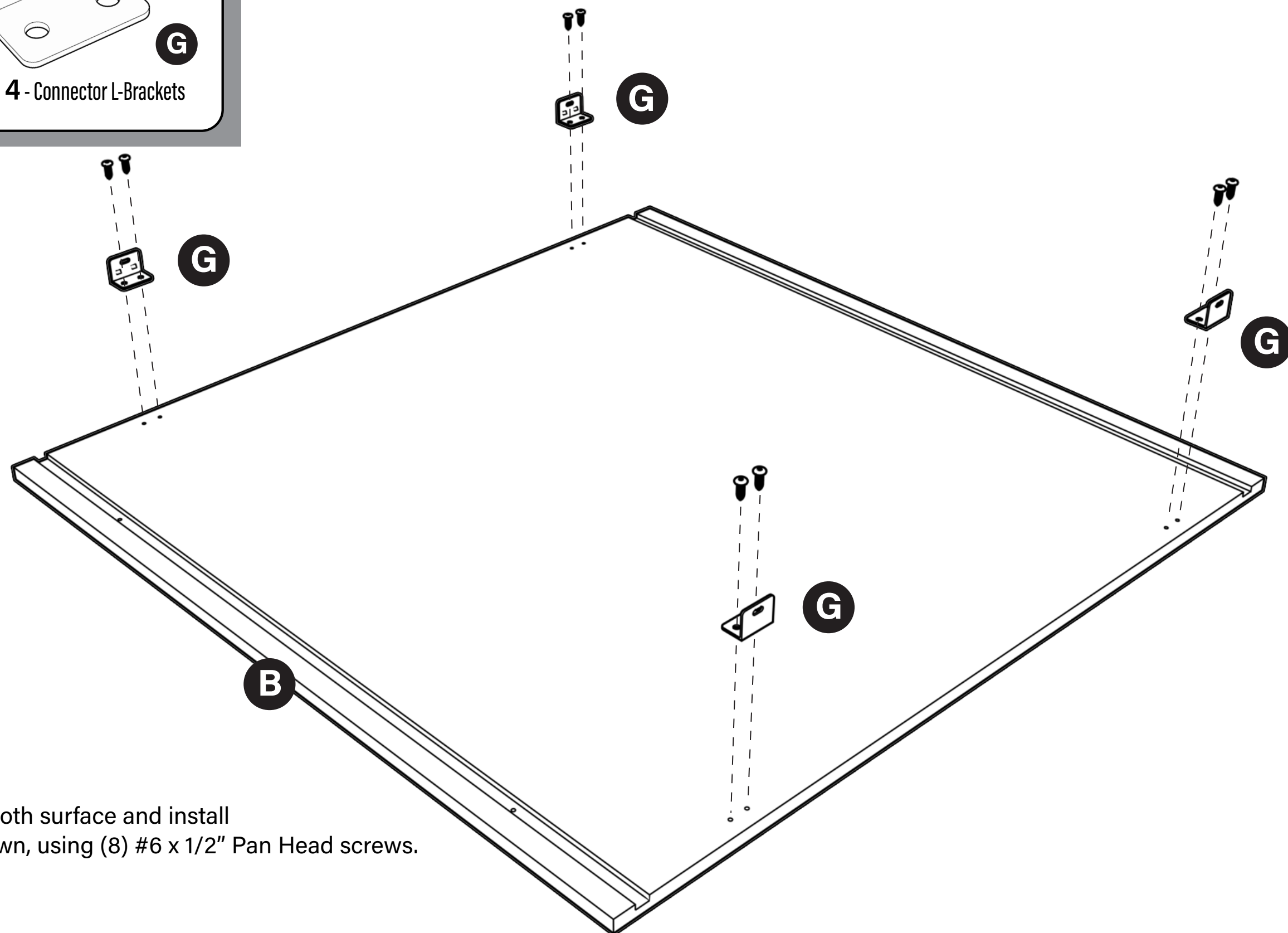
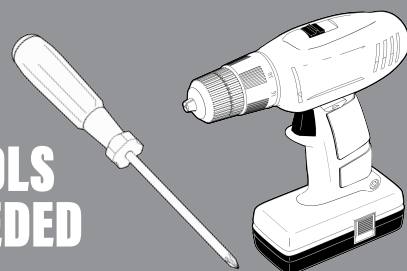

Place Back Panel (B) on a flat smooth surface and install (4) tan RTA L-Brackets (G), as shown, using (8) #6 x 1/2" Pan Head screws.



# STEP 3

## Parts List

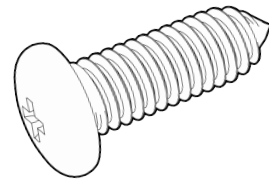

16 - #6 x 1/2" Pan Head Screws

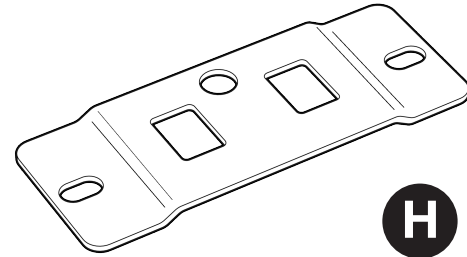

8 - Connector L-Brackets

## TOOLS NEEDED

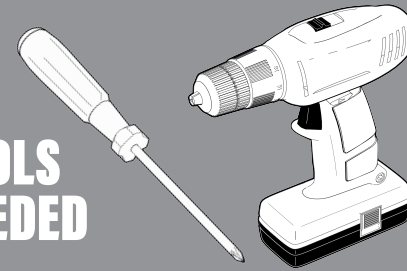

Ensure the central locking hole on the plate is located away from the edge of the panel

Central Locking Hole

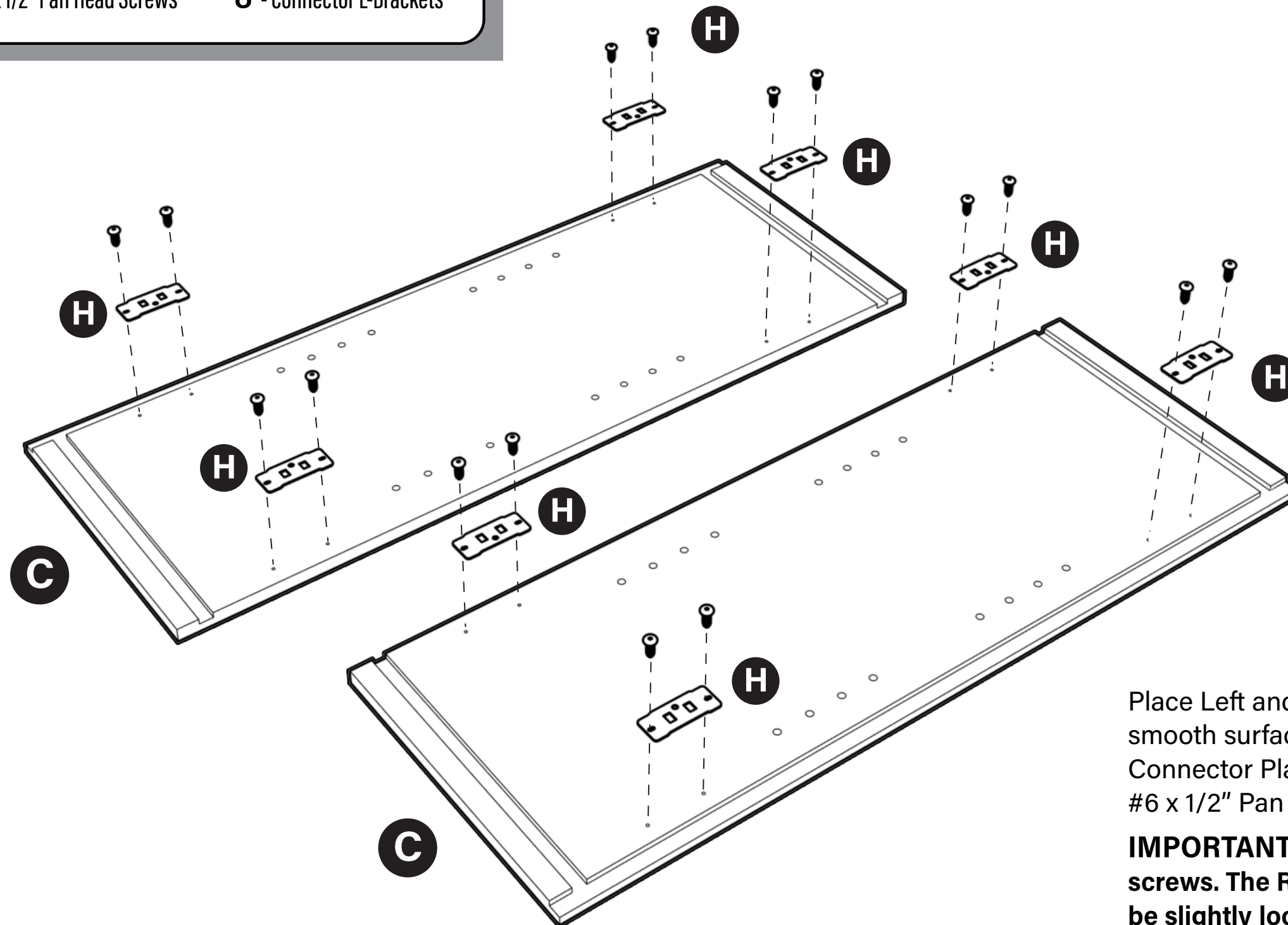

Place Left and Right End Panels (C) on a flat smooth surface and install (8) x tan RTA Connector Plates (H), as shown, using (16) #6 x 1/2" Pan Head screws.

**IMPORTANT:** Do not fully tighten the screws. The RTA Connector Plates need to be slightly loose

# STEP 4

## Parts List

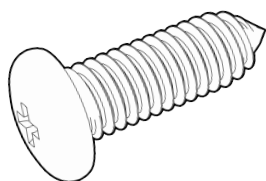

4 - #6 x 1/2" Pan Head Screws

## TOOLS NEEDED

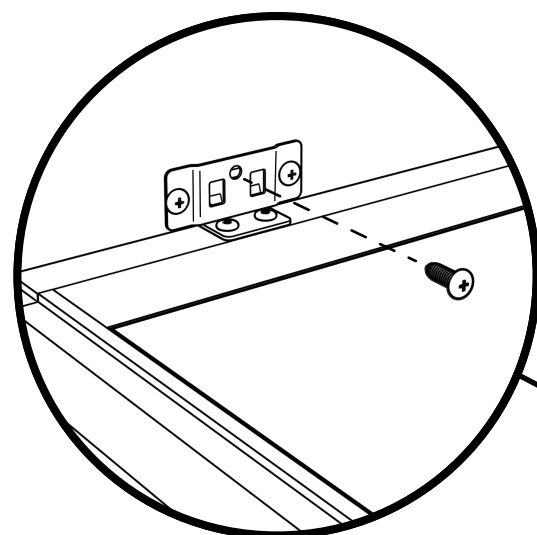
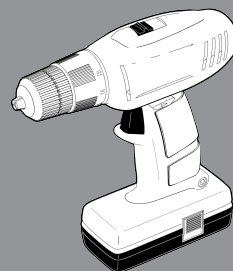
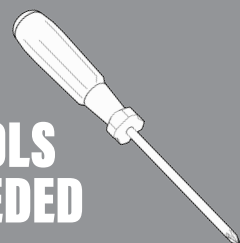

Run a bead of wood glue in the vertical grooves in the Frame (A) and insert End Panels (C), so that L-Brackets (G) & Connector Plates (H) snap together. Align the End Panels with the Frame, so that the dado grooves line up. Now, tighten all the Connector Plate screws and secure the Connector Plates and L-Brackets with (4) locking screws: #6 x 1/2" Pan Head.

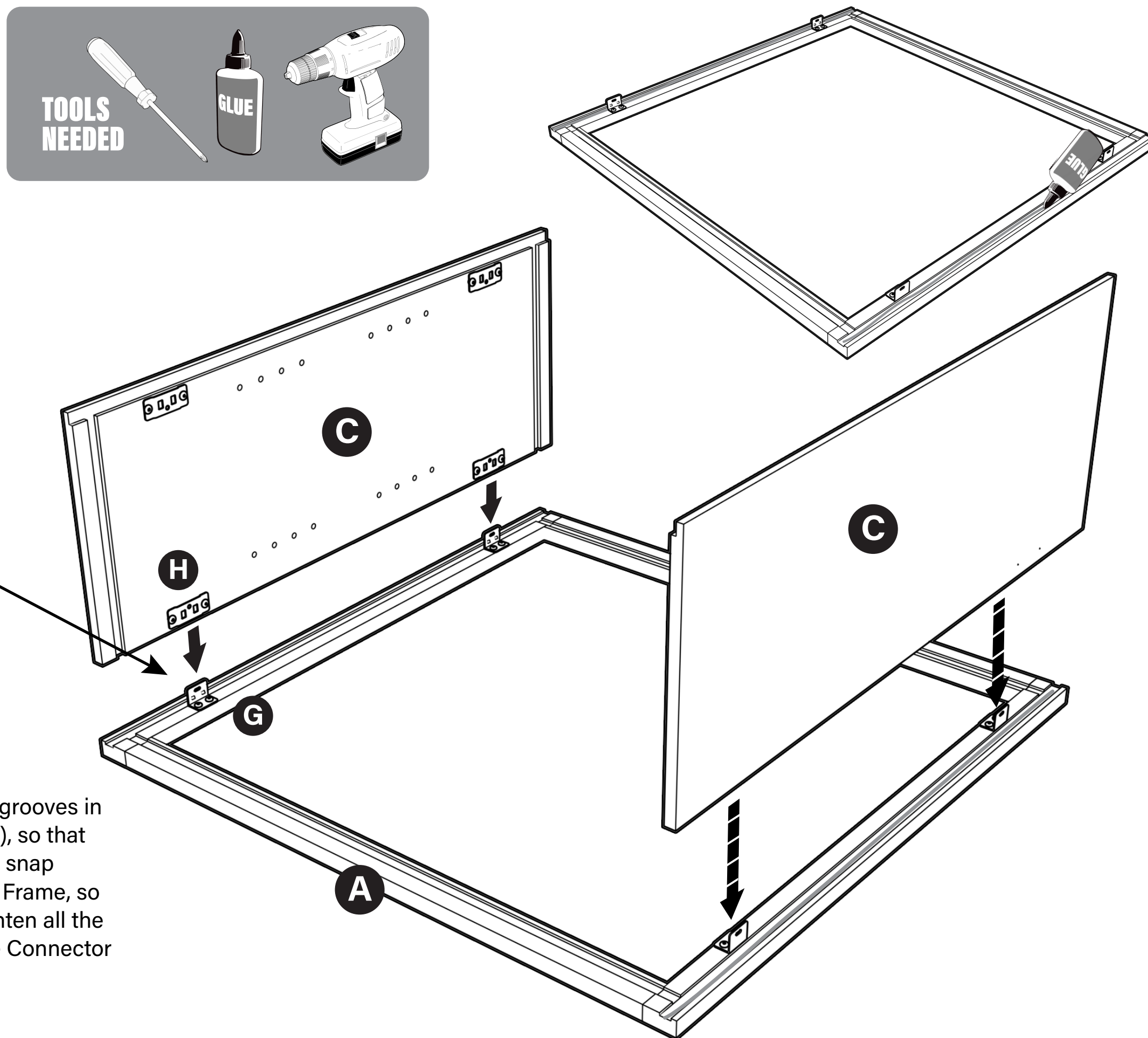

# STEP 5



TOOLS NEEDED

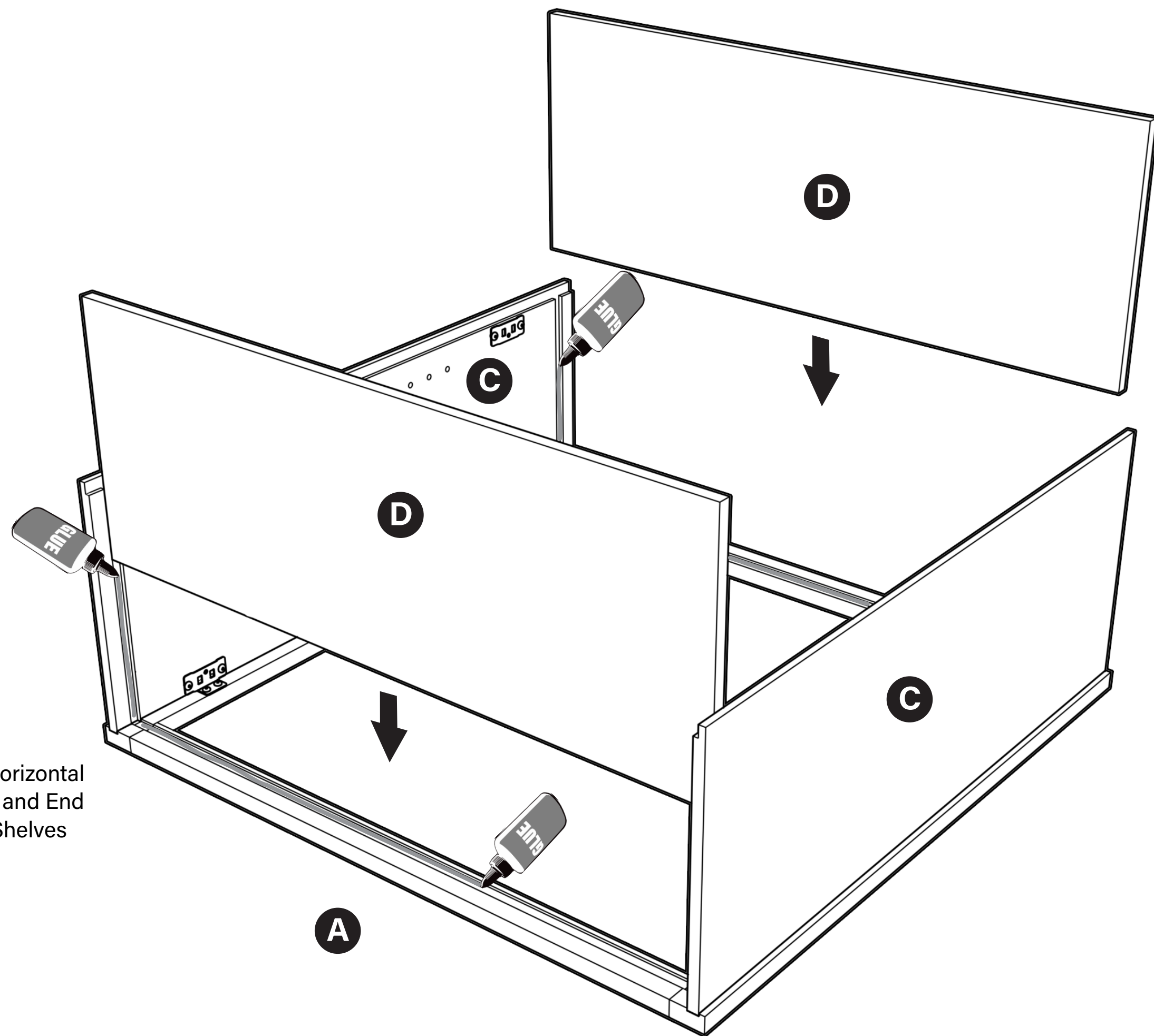

Run a bead of wood glue in the horizontal grooves in the back of Frame (A) and End Panels (C). Then slide the Fixed Shelves (D) completely into the grooves.

# STEP 6



TOOLS NEEDED

TOOLS  
NEEDED

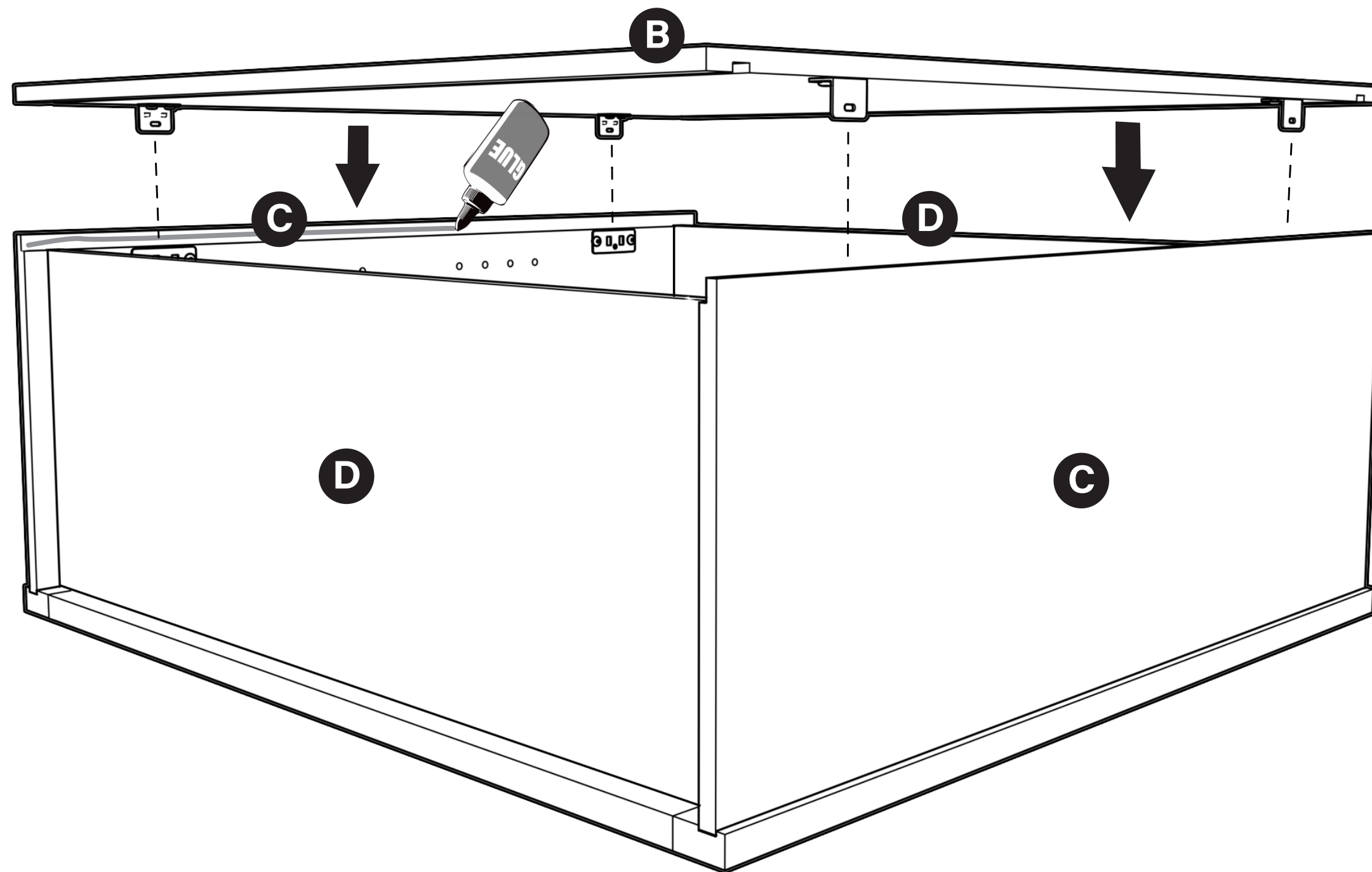
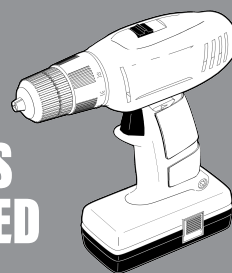

Apply beads of wood glue to the recesses along the back edges of the End Panels (C) and in the horizontal grooves in Back Panel (B). Carefully install Back Panel (B) so that the panels align and the L-Brackets & Connector Plates snap together. Ensure the Fixed Shelves (D) are seated fully in grooves in the Back Panel (B) and End Panels (C).



# STEP 7

## Parts List

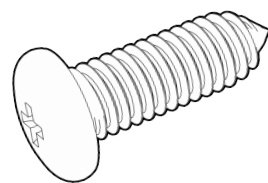

4- #8 x 1/2" Pan Head Screws

## TOOLS NEEDED

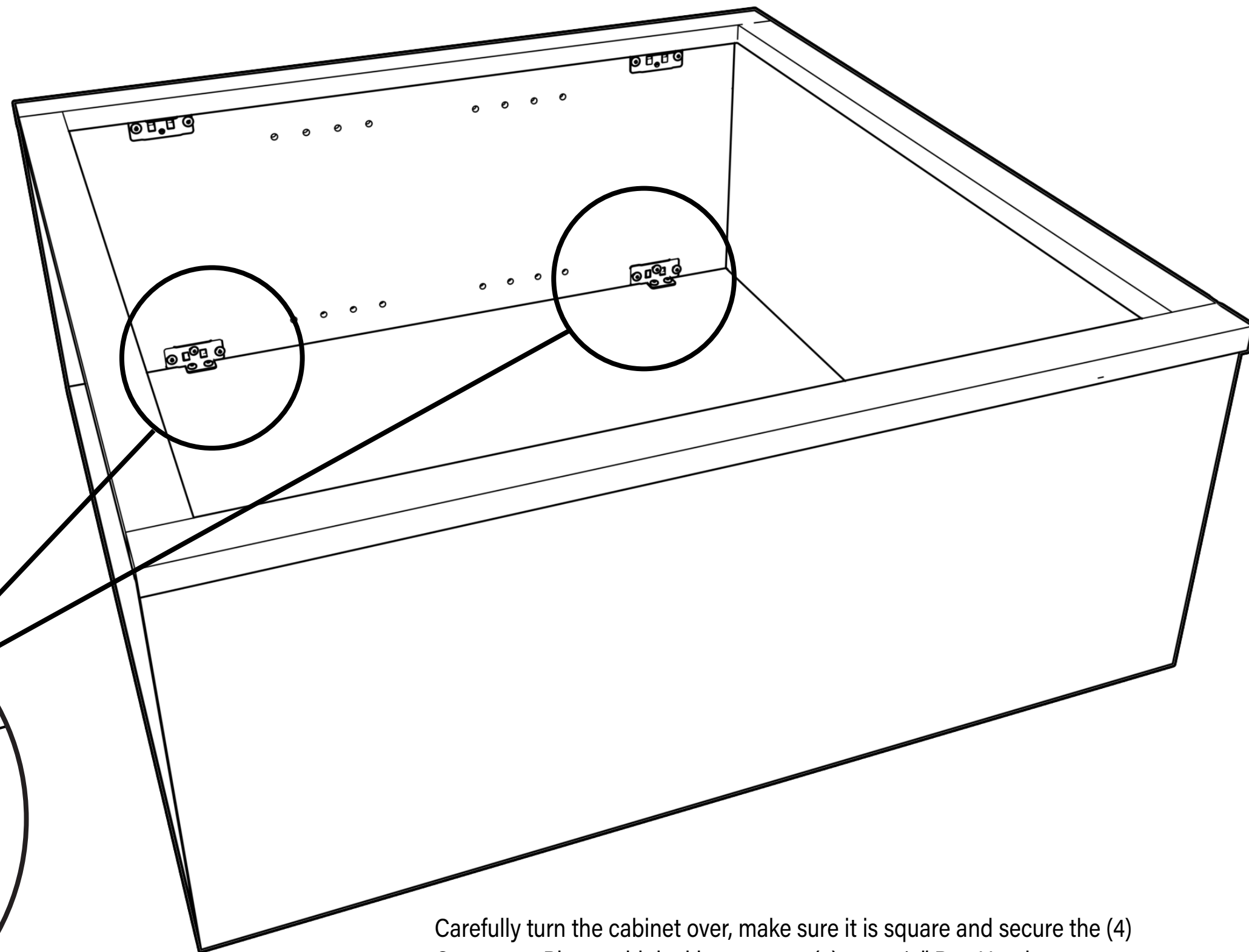
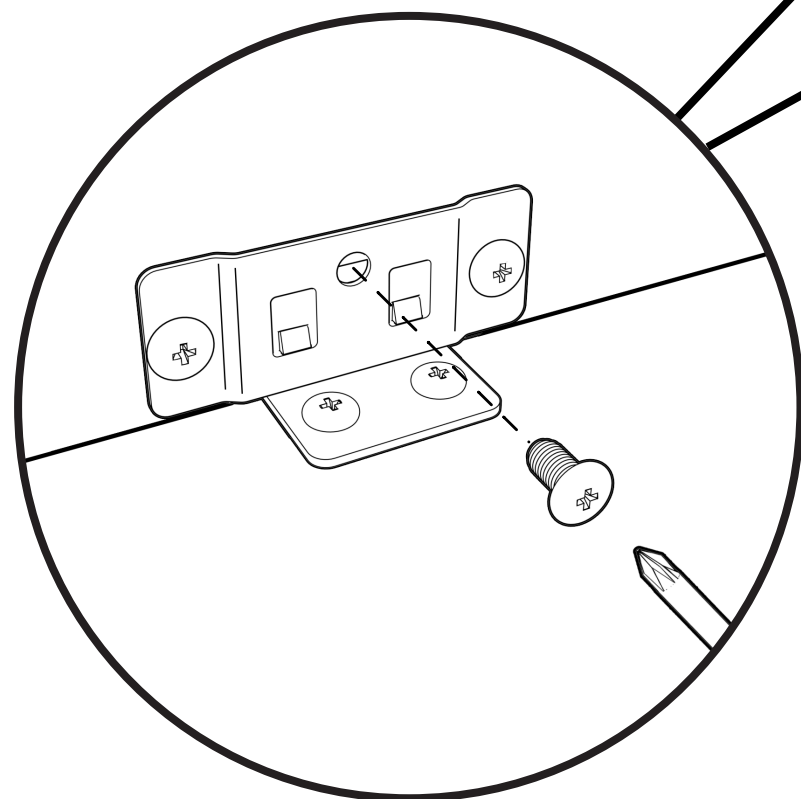
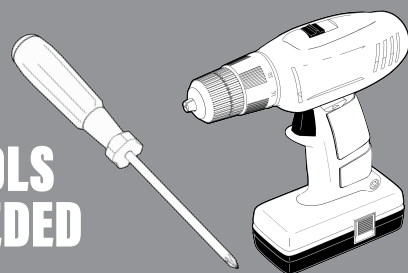

Carefully turn the cabinet over, make sure it is square and secure the (4) Connector Plates with locking screws: (4) #8 x 1/2" Pan Head screws.

# STEP 8

## Parts List

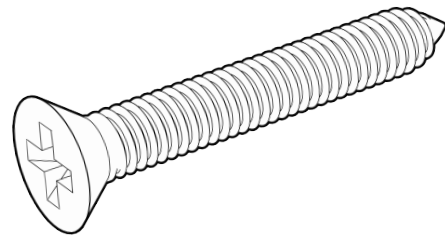

6- #6 x 1" Flat Head Screws

## TOOLS NEEDED

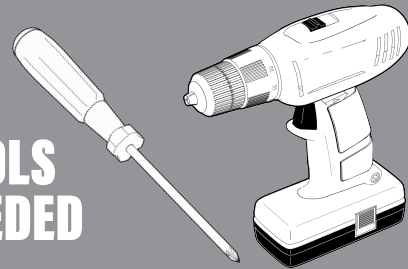

## Parts List

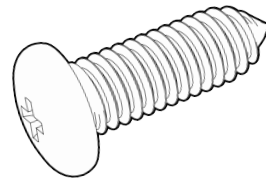

8- #6 x 1/2" Pan Head Screws

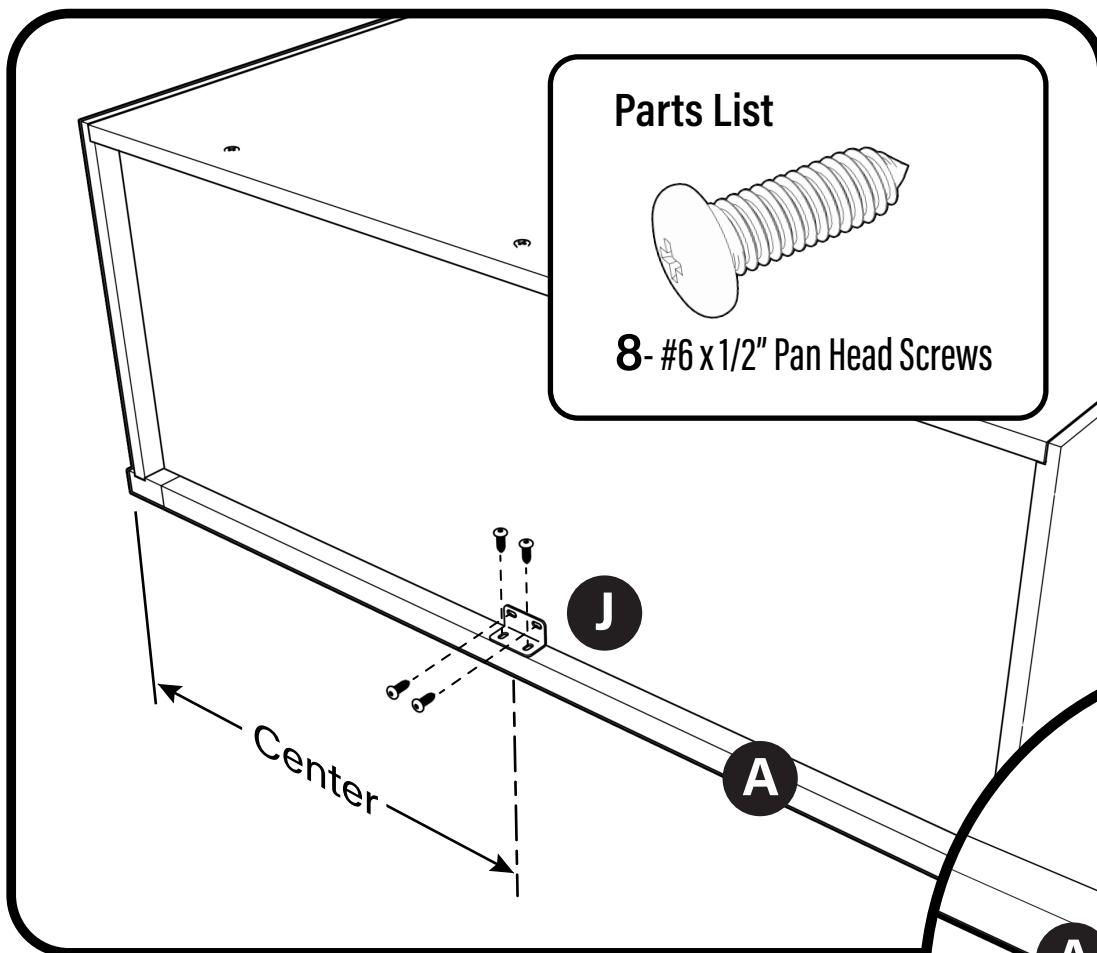

### **\*30" and 36" wide Cabinets Only!**

Install (2) Silver L-Bracket support (J) in the center of the Top and Bottom Rails of the Frame (A) using (8) #6 x 1/2" Pan Head screw.

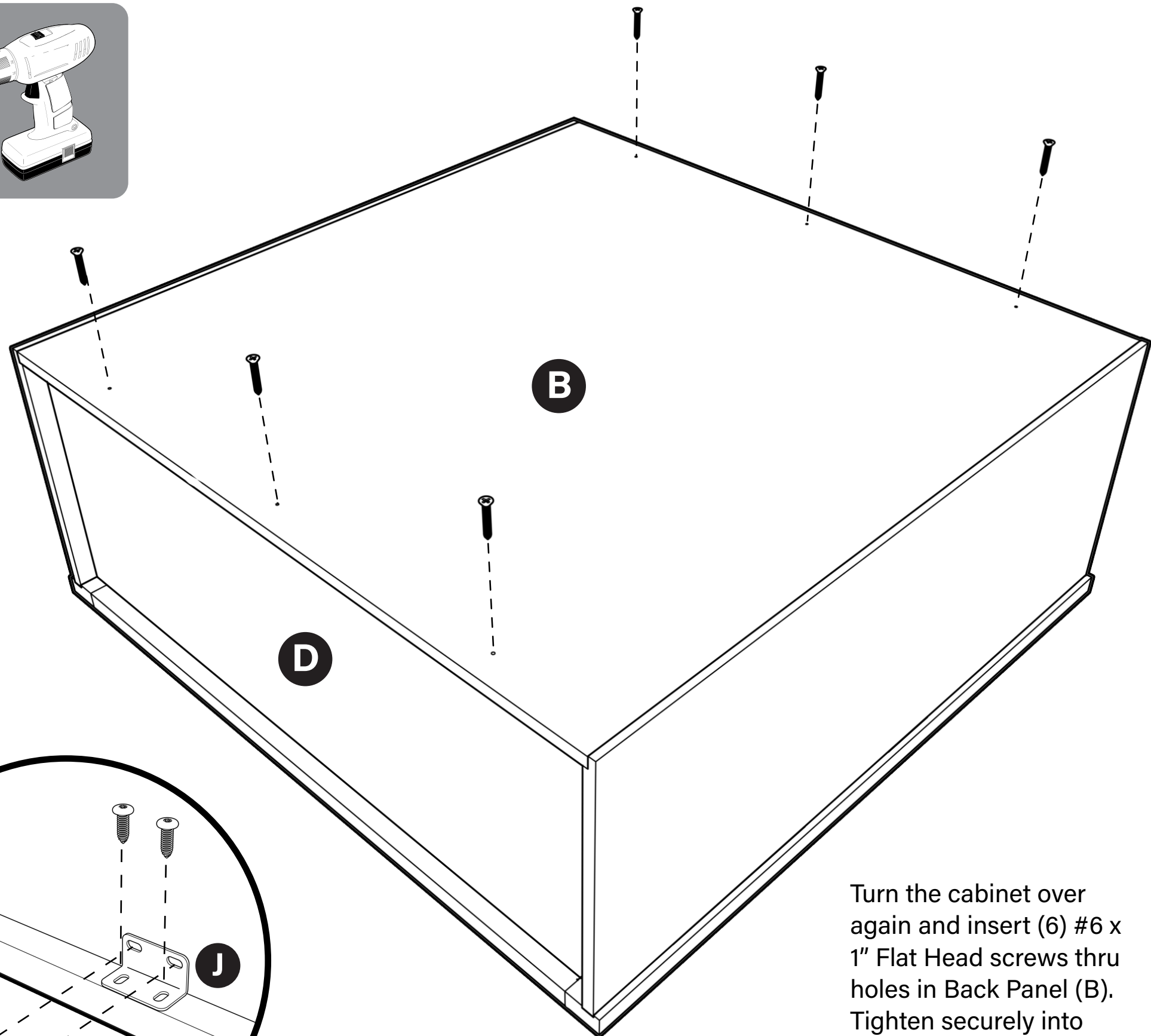
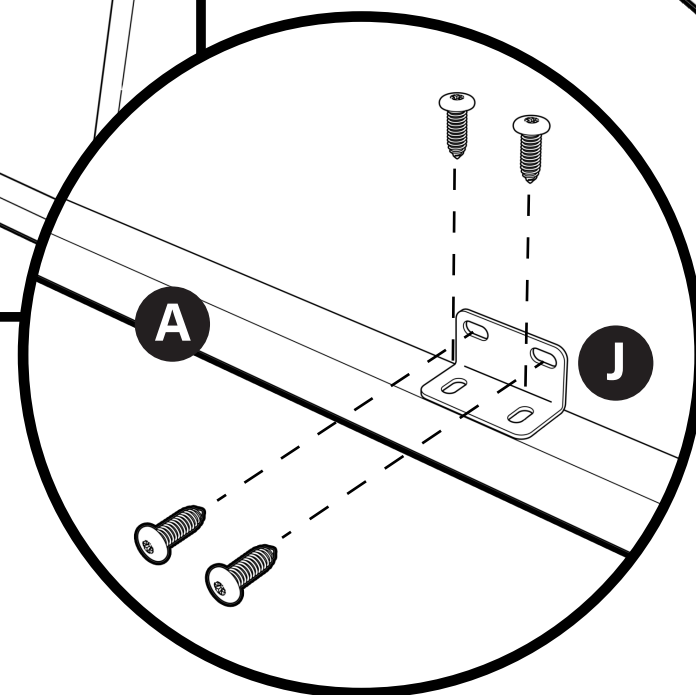

Turn the cabinet over again and insert (6) #6 x 1" Flat Head screws thru holes in Back Panel (B). Tighten securely into Fixed Shelves (D).

# STEP 9

## Parts List

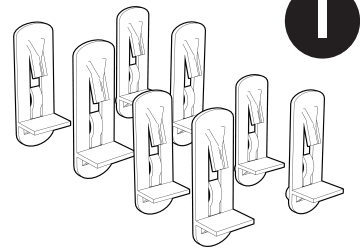

8 - Locking Shelf Rests

Insert (8) Locking Shelf Rests (I) in desired locations and install Adjustable Shelves (E)

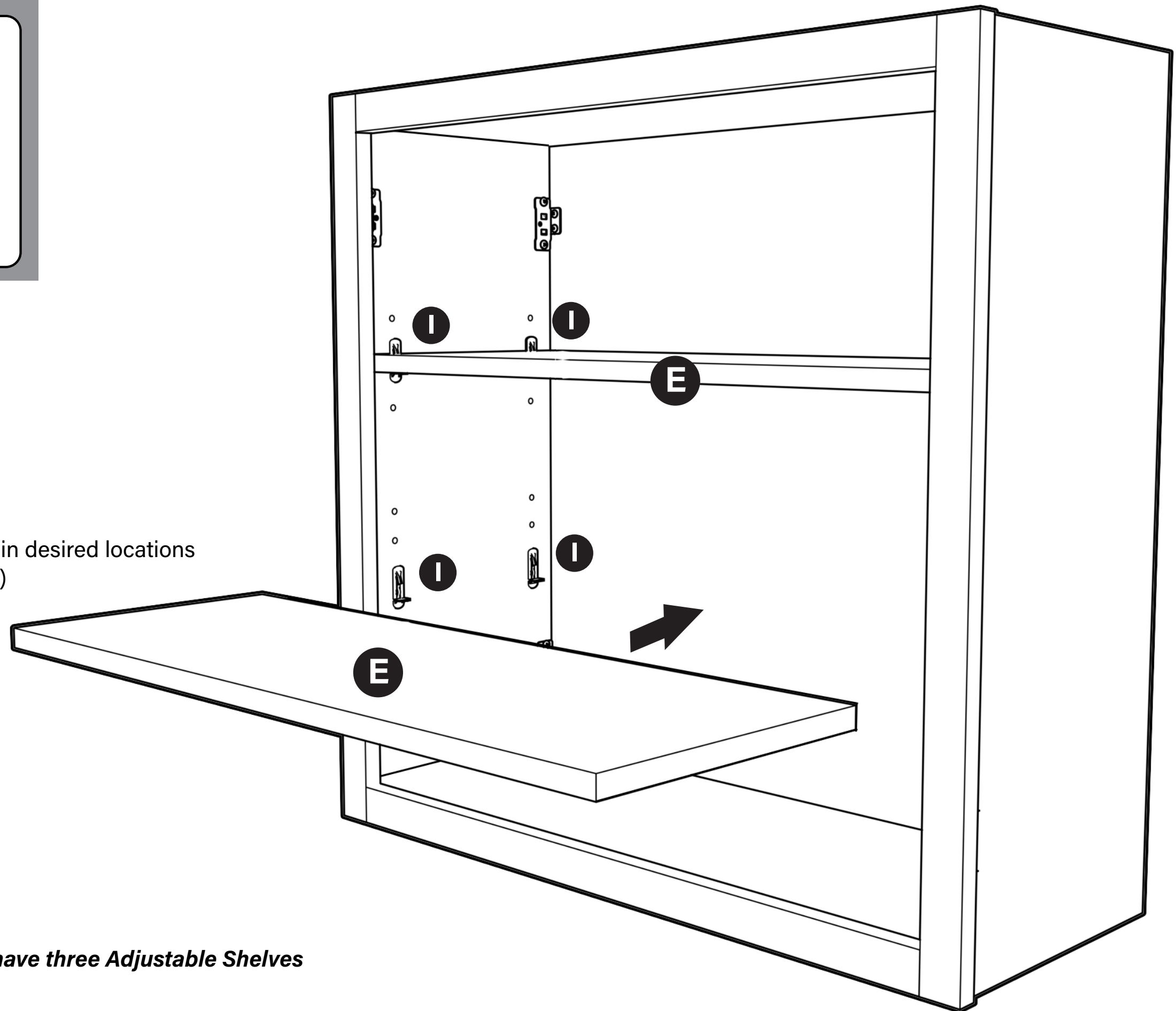

*\*36" and 42" high cabinet will have three Adjustable Shelves*

# STEP 10

## Parts List

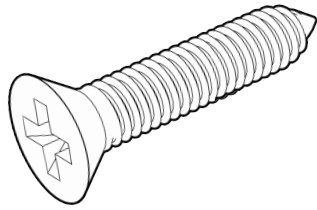

8- #6 x 5/8" Flat Head screws

## TOOLS NEEDED

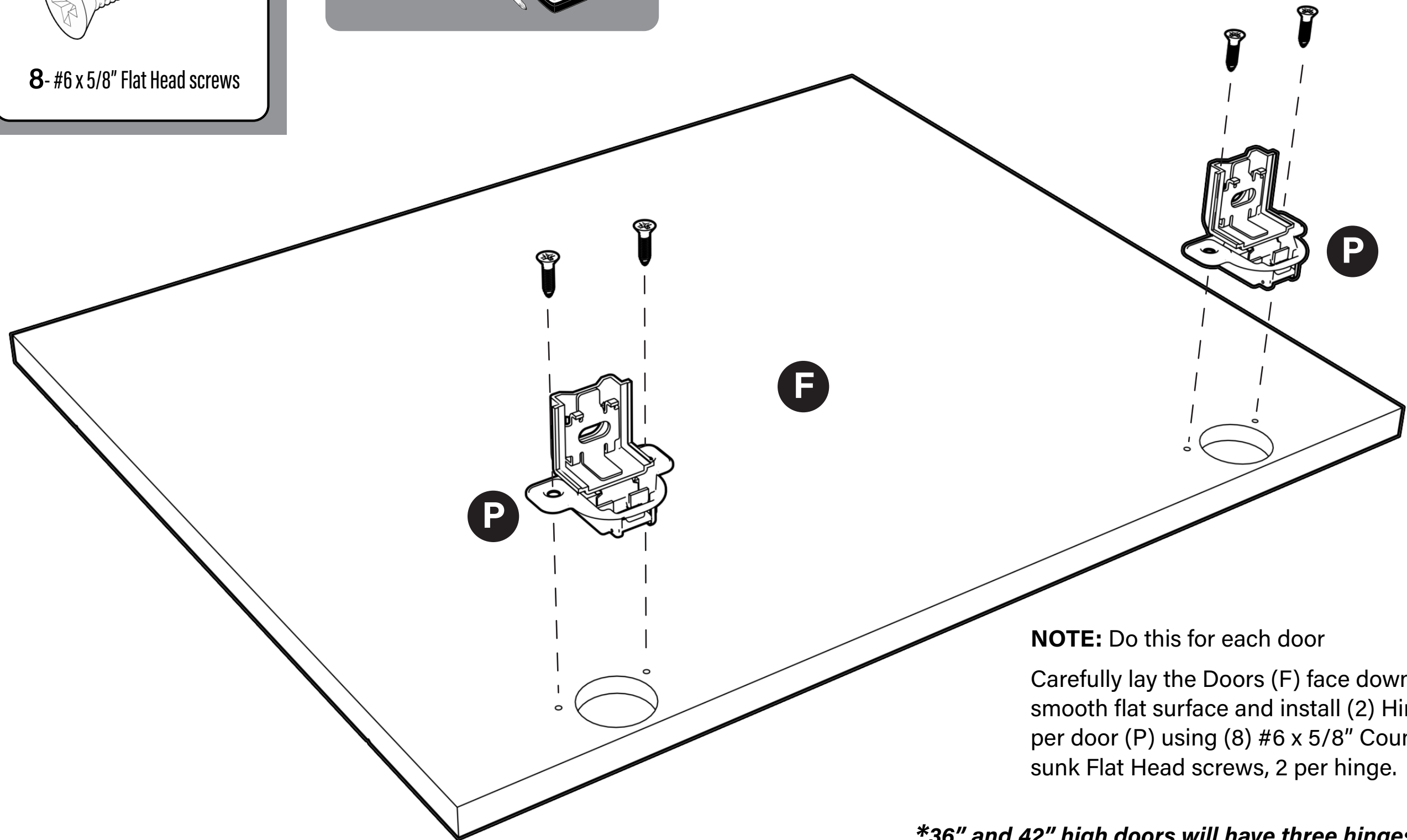
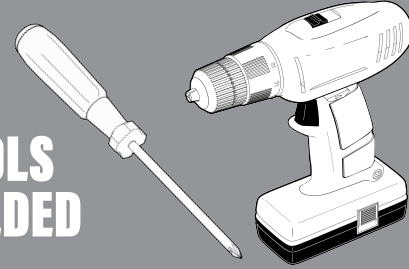

**NOTE:** Do this for each door

Carefully lay the Doors (F) face down on a smooth flat surface and install (2) Hinges per door (P) using (8) #6 x 5/8" Counter-sunk Flat Head screws, 2 per hinge.

*\*36" and 42" high doors will have three hinges each*



# STEP 11

## Parts List

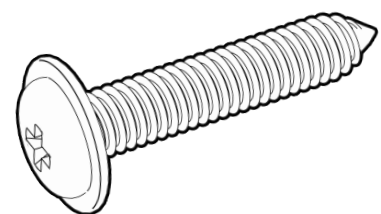

4 - #8 x 1/2" Pan Head Screws

## TOOLS NEEDED

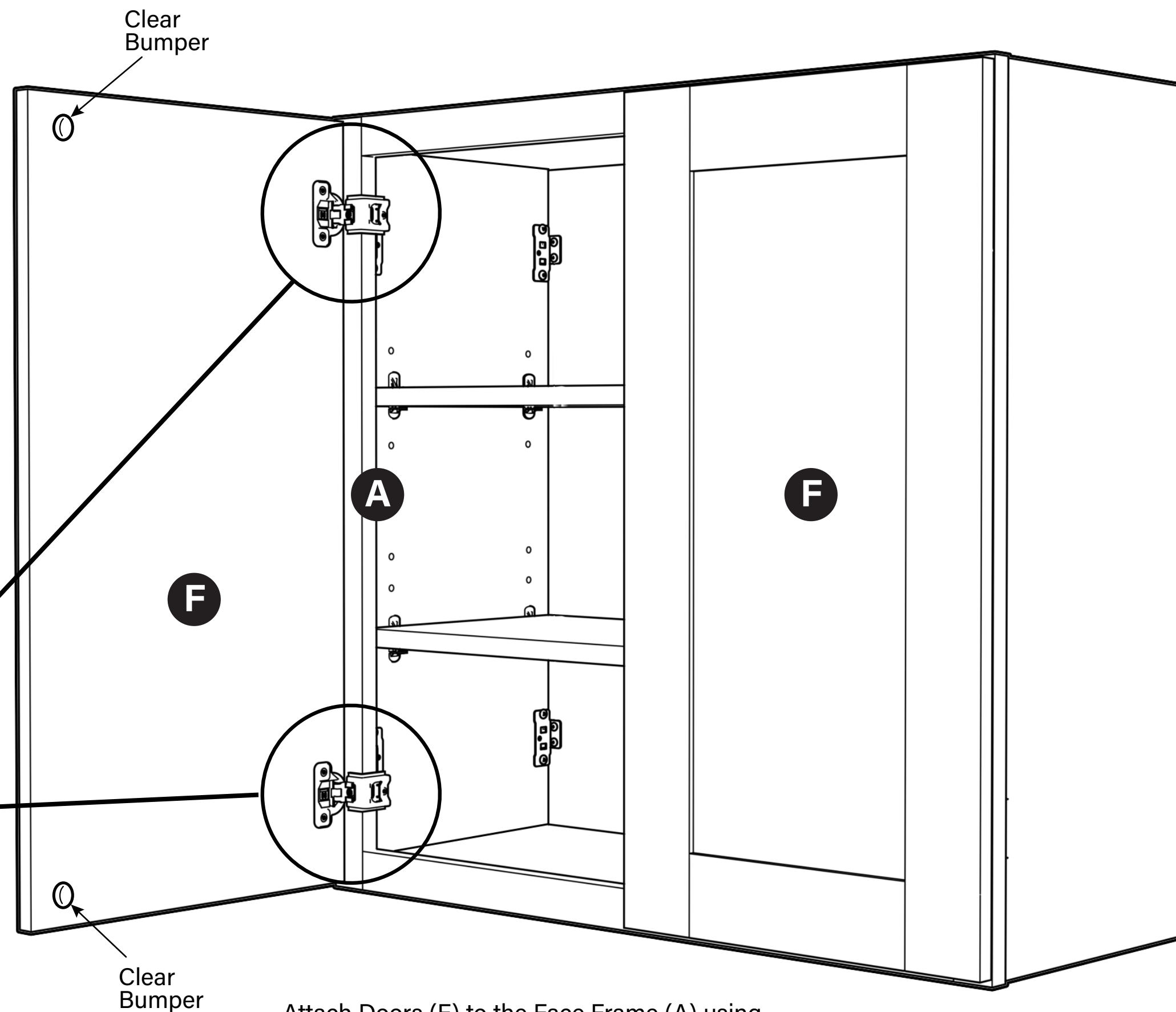
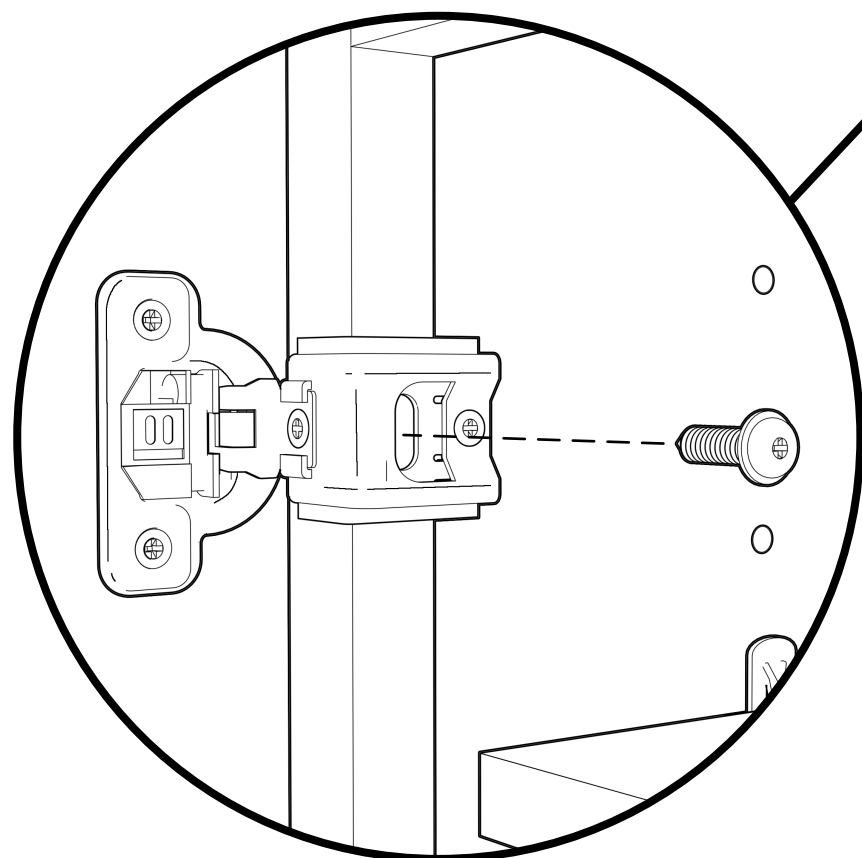
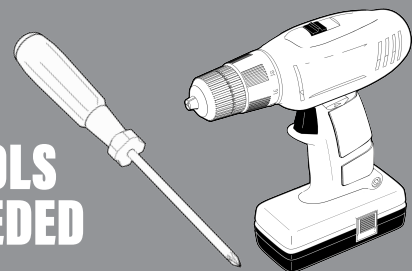

Attach Doors (F) to the Face Frame (A) using (4) #8 x 7/8" Pan Washer Head screws and install (4) Clear Bumpers, 2 on each door.

# CONGRATULATIONS

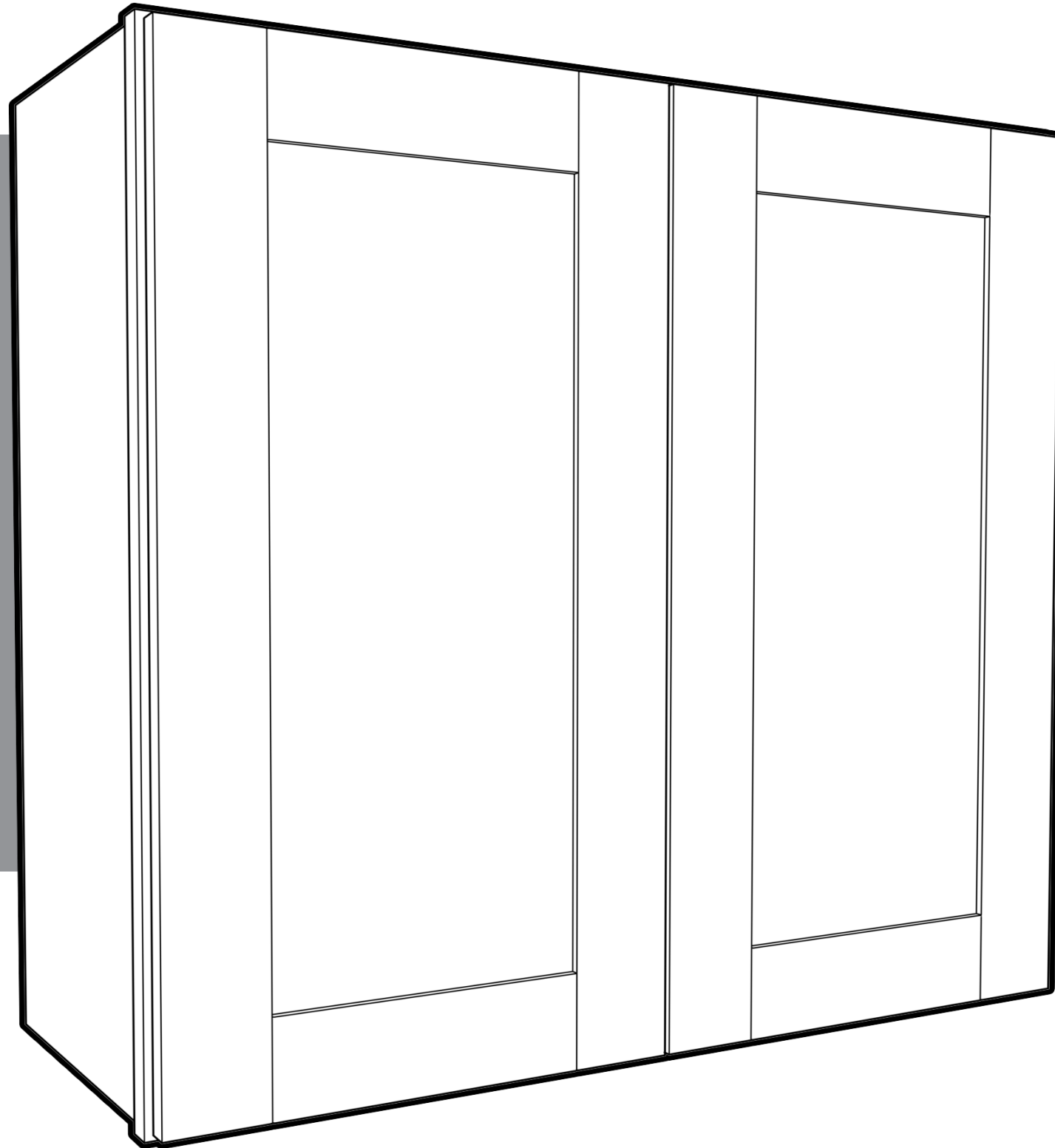

# ENJOY!